

## FIXING ON PROFILED STEEL DECKING

It is most important to position the steel decking correctly before fixing the connectors. The decking must be placed in adherence with the beams, and the connectors in perfect contact with both the beam and metal decking. When sheets overlap, they must remain united and in adherence with the beam. No more than two sheets (each with a maximum thickness of 1mm9 can be used and with no more than a total thickness of 2mm. The maximum thickness of a single sheet is 1.25mm.

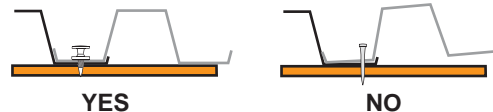

The decking must be fixed to the beams with nails or screws specifically designed for this purpose (for example SBR14 or HSBR14). A metal washer must be used in the fixing to ensure that the decking is pushed downwards to be in contact with the beam.



Connectors cannot be fixed where there is a joint between two beams with the presence of a jointing plate and where there are bolts. The decking must be positioned as shown in the diagram.

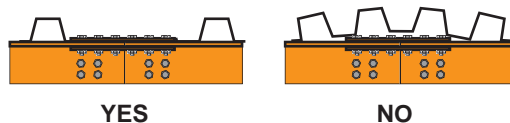

When two sheets of decking meet head to head, they must be butt jointed and not overlapped. Therefore any overlapping in this direction is best avoided when laying the sheets, otherwise the sheets will have to be cut when in position. An adhesive tape must be used to close any gap between the joint in the sheets to avoid any possibility of concrete dripping through the joint.

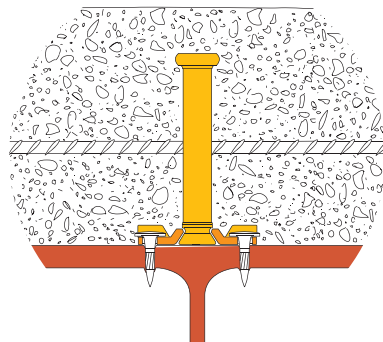
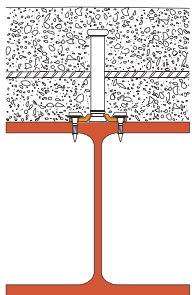
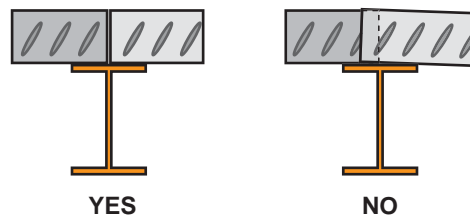

the fixing process can be considered as satisfactory even if the nails protrude through the upper steel plate of the beam. However it is advisable to carry out a mechanical test to ensure that the fixing is solid.

# TECNARIA®

## CHECK FOR CORRECT FIXINGS OF THE CONNECTORS



## CTF Connectors

For the use instruction of the P560 tool see the attached instructions

Tecnaria Spa  
 Viale Pecori Giraldi, 55  
 36061 Bassano del Grappa (VI) - ITALY  
[www.tecnaria.com](http://www.tecnaria.com)  
[info@tecnaria.com](mailto:info@tecnaria.com)  
 TEL: +39.(0)424.502029  
 FAX: +39.(0)424.502386

## FIXING THE CONNECTOR AND VERIFYING THE RESULT

The CTF connector is supplied with 2 nails and 2 cartridges. The fixing process must be undertaken by a qualified person who has read and understood the instructions and indications relative to the fixing. These can be found inside the box of the SPIT P560 nailer. Use only the SPIT P560 power nailer (cod. 013091) and the approved fixing kit for fixing the CTF connector (cod. 013994).

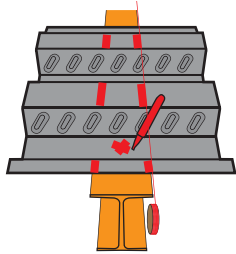

It is important to locate the exact position of the beam under the **SHEET DECKING** before any fixing takes place. It is suggested that, in the area where the connectors are to be placed, a line is traced with a thread or marked with a pen. Each connector must be fixed with two nails.

The connector should always be positioned at right-angles to the beam when fixing on a **SOLID SLAB** (fig.A). When the upper plate of the steel beam is less than 6mm thick, rotate the connector through 45° so as the nails can be fixed nearer to the central part of the beam (fig.B). Two checks must be made to verify the efficiency of the fixing, one mechanical, one visual.



Fig. A

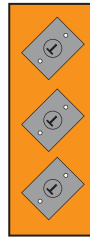

Fig. B

## CHECKING PROCEDURE - BENDING OF THE SHANK

This test should be carried out on one of the first connectors to be fixed in position for every type of beam and every quality of steel. The test will partially destroy the connector so a new one must be fixed close to the bent one. A second test should be undertaken at random every so often to ensure the fixing is verified and that the nailer is working properly.

- 1) Fix the CTF connector with 2 nails
- 2) Insert a tube over the shank of the connector until it touches the baseplate. Bent the shank through 45° as shown in the diagram without pulling out the nails. The test can be considered positive if the base plate remains fixed and adheres to the beam. It is normal that the shank moves slightly on the baseplate after the test has been made.

If the test has a negative result, it means that the cartridge is underpowered and that a more powerful one be used. If there are problems consult Tecnaria at 0039 (0)424 502029.

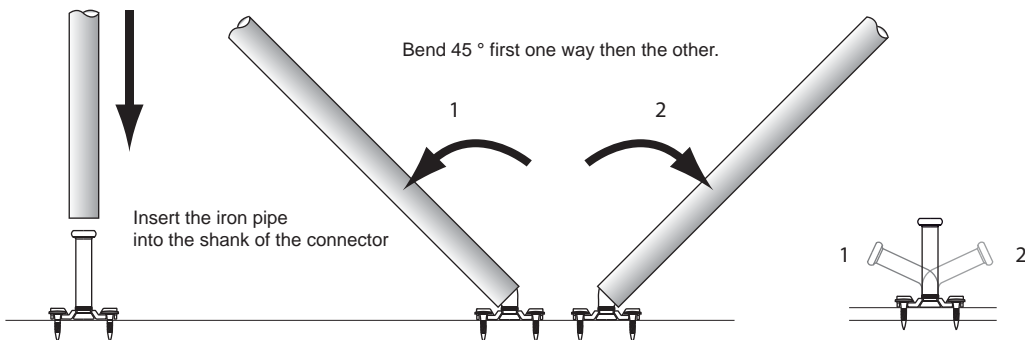

## VISUAL TEST

Measure the distance between the nail and base plate of the connector using the attached “card” to verify the correct fixing. The value must be between 3.5mm (MAX) and 7.5mm (MIN).  
When the value is less than 3.5mm

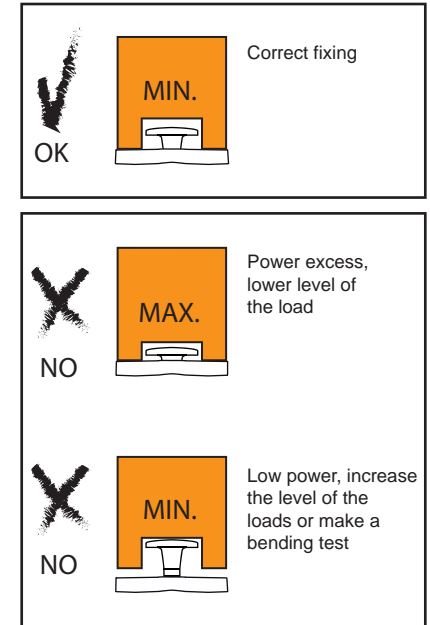

Values less than 3.5 mm (MAX):

The quality of the fixing is not affected. However it is advisable to use a lower powered cartridge to insert the nails. This avoids causing damage to the nailer.

When the value is greater than 7.5mm

This means that the nails have not sufficiently penetrated the upper plate of the beam. A more powerful cartridge must be used. If there are problems consult Tecnaria at 0039 (0)424 502029.

## POWER LEVEL (LOADS)

- Green: ■ Very weak (3) cod. 031250
- Yellow: ■ Weak (4) cod. 031240
- Blue: ■ Medium (5) cod. 031230
- Red: ■ Strong (6) cod. 031220
- Black: ■ Very strong (7) cod. 031210

