

# OPERATING INSTRUCTION FOR THE SPIT P560 TOOL with special adaptor (Pin Guide) for CTFS shear connector

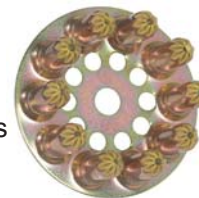

Black cover button n° 24



Disk of cartridges

- 1) Press the button (n° 24) to open the cover (n° 23)
- 2) Fully open the pin guide (n°1)
- 3) Place the disc in the housing
- 4) Close the cover (n° 23)

## LOADING THE CARTRIDGES



Fully open the pin guide (n°1).  
Hold the tool with the pin guide pointing vertically upwards. Insert the nail into the hole of the pin guide (head first). A magnet will keep the nail in the correct position.  
Point the tool towards the ground. Now the tool is ready for firing.

Hold the tool and the connector perpendicular to the work surface, press firmly against the working surface and pull the trigger.

## LOADING THE PINS



In order to reload the tool fully extract the pin guide and repeat the procedure. Each disc contains 10 cartridges

## RELOADING

**NEVER USE THE HAND OR OTHER BODY PART TO PUSH BACK THE pin guide!!**

# TECNARIA®

Viale Pecori Giraldi, 55  
36061 Bassano del Grappa (VI) ITALY  
www.tecnaria.com info@tecnaria.com  
TEL: +39.0424.502029  
FAX: +39.0424.502386

# Maintenance of the tool

During the maintenance operations the tool **MUST** be unloaded (and always unloaded when stored in the case).

**Make sure that no nails and loads are present into the tool**

The tool must be cleaned periodically (after approximately 1000 shots).

Disassembling the front part of the tool for cleaning:

Push the pin guide (1) back completely, lift the catch (38) and pull out the front part assembly [pin guide (1) + barrel (17)] from the body of the tool.

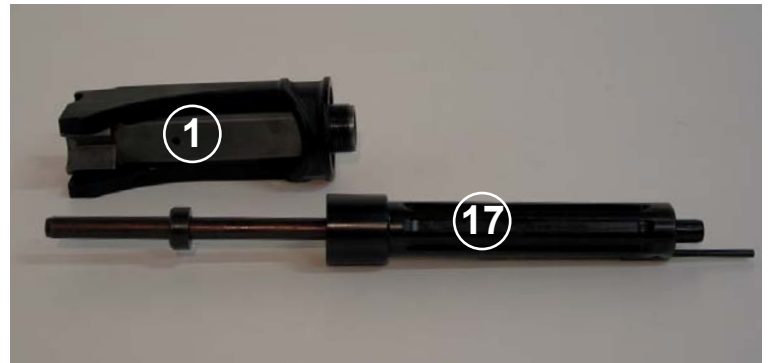
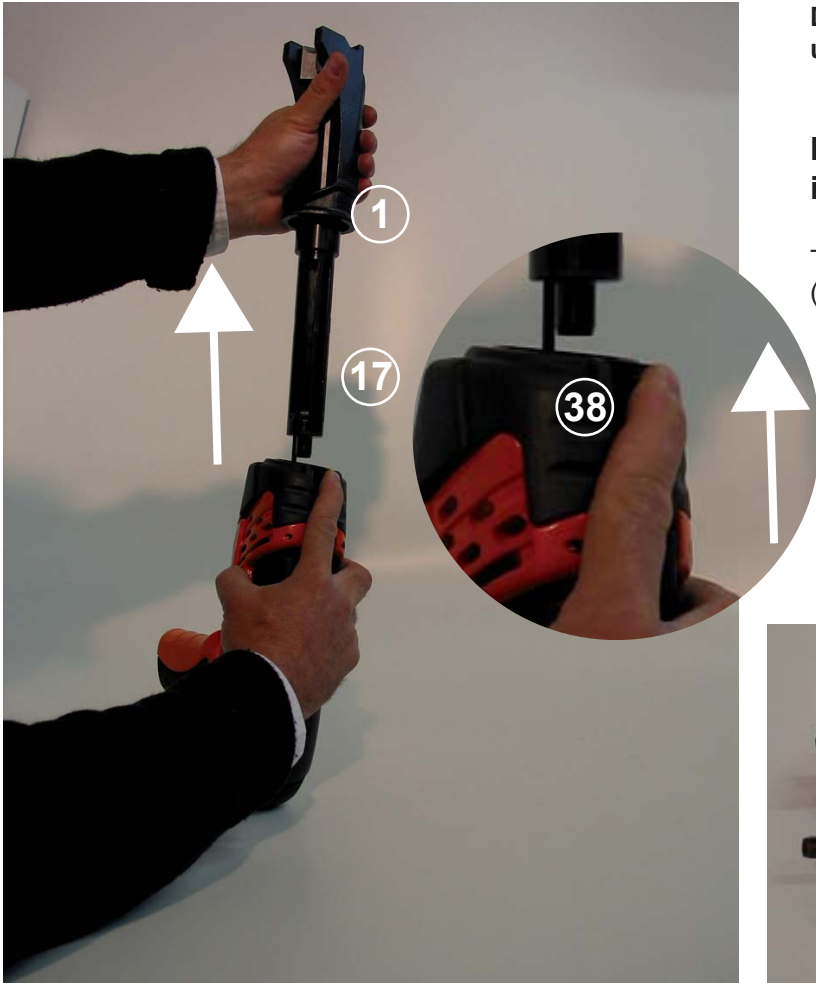

Unscrew the drive pin (1) from the barrel (17)

- Clean with the metallic flat brush (A) the exterior part of the barrel (17).
- Clean with the bigger round plastic brush (B) the interior part of the barrel (17) and the interior part of the body of the tool
- Clean with the smaller round plastic brush (B) the cartridge chamber positioned in the back side of the barrel

- Lubricate the cleaned parts lightly using spray oil (SPIT or equivalent).

**Check the condition of the piston (15) and the condition of the stop ring (14)!**



The stop ring (14) **MUST** be changed when deformed or damaged (see picture).

The piston must be changed when the end part is damaged (see picture).

Extract the piston from the barrel (17) and change it. Do not forget to insert the stop ring (14).

